

mayur  
DAFFODIL



Apartment at Sarjapura



## LIFE IN THE MIDST OF NATURE

Mayur Daffodil, is an exclusive Ready to move in 96 flats apartment in Sarjapur. Mayur Daffodil is ideal combination of unique natural surroundings with luxury and tranquility for all those who would like to be close with nature. It's perfectly planned spaces with an abundance of light and ventilation, premium specifications and fixtures, state of the art amenities and landscaped gardens promises an unmatched quality of life.

## SITE PLAN



No. of Floors	G+3 Floors
No. of Flats	96 Flats
Parking	Basement
No. of Lifts	2 Lifts

### Amenities

- Children Play Area
- Party hall
- Landscaped Garden
- 24x7 Security
- 24/7 Power Backup
- STP
- Lifts



Flat No	1006, 3008
Type	1 BHK
Facing	West
SBA	980 Sft

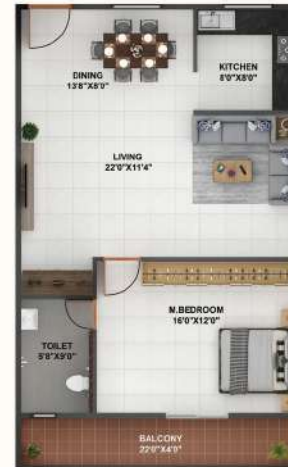

Flat No	2017
Type	1 BHK
Facing	East
SBA	960 Sft





Flat No	002, 003, 004, 005, 1009, 1010, 2002, 2004, 2005, 3009, 3010, 3011, 3012
Type	2 BHK
Facing	West
SBA	1205 Stt



Flat No	3024
Type	2 BHK
Facing	West
SBA	1275 Stt

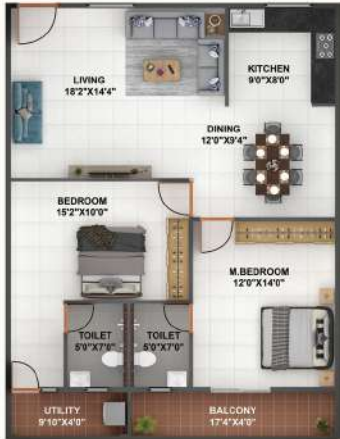

Flat no	016, 205, 1020, 1021, 1022, 1023
Type	2 BHK
Facing	East
SBA	1205 Stt

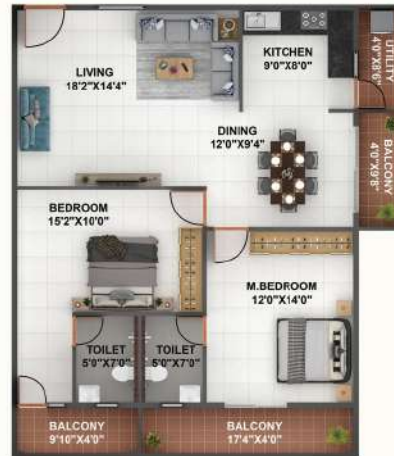

Flat No	013, 2013
Type	2 BHK
Facing	East
SBA	1300 Stt



# LOCATION MAP

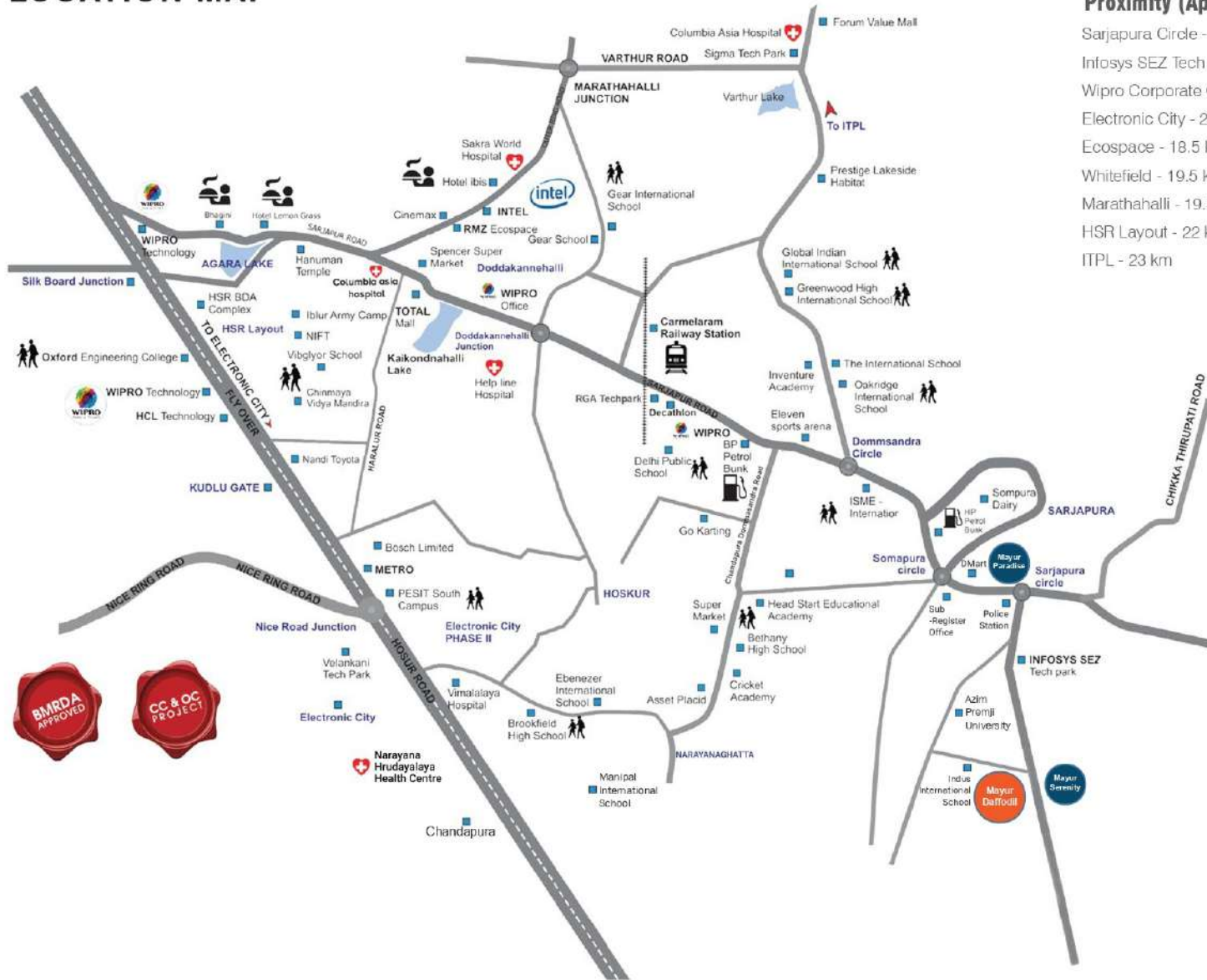

## Proximity (Approx)

- Sarjapura Circle - 3.5 km
- Infosys SEZ Tech Park - 3.9 km
- Wipro Corporate Office - 16 km
- Electronic City - 22 km
- Ecospace - 18.5 km
- Whitefield - 19.5 km
- Marathahalli - 19.5 km
- HSR Layout - 22 km
- ITPL - 23 km



**BHP HOUSING**  
Call: 8884775999